

IT-30CIID



FEATURES

- Rigorously tested to ensure decades of use
- Exceptional support from Madison, WI-based Customer Care team
- Ready to be fitted with custom panels and handles to blend with cabinetry
- Over-and-under refrigerator/freezer storage
- Nano-coated spill-proof shelves for easy clean-up
- Dual refrigeration keeps food fresher longer
- Air purification system fights spoilage, odors
- Crispers and deli drawers in low-temp, high-humidity zones for optimum freshness
- Automatic ice maker with "max ice" feature
- Internal water dispenser works with seamless design
- Water-filtration system reduces contaminants, chlorine taste and odor

ACCESSORIES

- 30" Drawer Panels with Pro Handles
- 30" Drawer Panels with Tubular Handles
- 48" Stainless Steel Kickplate
- 54" Stainless Steel Kickplate
- 60" Stainless Steel Kickplate
- 66" Stainless Steel Kickplate
- Air Purification Cartridge
- Dual Installation Kit Handle to Handle
- Dual Installation Kit Hinge to Handle
- Dual Installation Kit Hinge to Hinge
- Egg Container
- Reduced Toekick Divider
- Stainless Steel 30" Drawer Panels with Pro Handles
- Stainless Steel 30" Drawer Panels with Tubular Handles
- Stainless Steel Door Panel with Pro Handle - LH
- Stainless Steel Door Panel with Pro Handle - RH
- Stainless Steel Door Panel with Tubular Handle - LH
- Stainless Steel Door Panel with Tubular Handle - RH
- Stainless Steel Side Panel
- Stainless Steel Top Panel
- Water Filter 4204490
- Stainless Steel Tubular Handles
- Stainless Steel Pro Handles



HANDLE ACCESSORIES

PRO



TUBULAR



PRODUCT DETAILS

REFRIGERATOR

- Three adjustable glass shelves
- One stationary shelf
- Crisper drawer with two adjustable dividers
- Adjustable dairy compartment
- Two adjustable door shelves
- One stationary door shelf

FREEZER

- Three adjustable drawer dividers
- Removable ice container
- Automatic ice maker
- Air purification system

Accessories are available through an authorized dealer.
For local dealer information, visit subzero-wolf.com/locator.

Specifications are subject to change without notice. This information was generated on November 28, 2021. Verify specifications prior to finalizing your cabinetry/enclosures.

30" DESIGNER OVER-AND-UNDER REFRIGERATOR/FREEZER WITH ICE MAKER AND INTERNAL DISPENSER - PANEL READY



PRODUCT SPECIFICATIONS

Model	IT-30CIID
Dimensions	30"W x 84"H x 24"D
Door Clearance	28 1/2"
Drawer Clearance	18 3/8"
Weight	400 lbs
Refrigerator Capacity	10.6 cu. ft.
Freezer Capacity	5 cu. ft.
Electrical Supply	115 VAC, 60 Hz
Electrical Service	15 amp dedicated circuit
Receptacle	3-prong grounding-type

DIMENSIONS

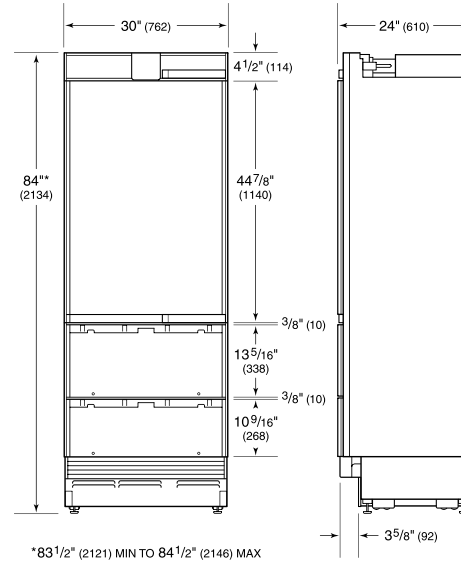

ELECTRICAL

PLUMBING

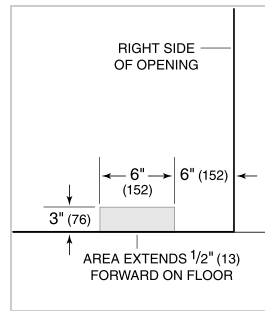
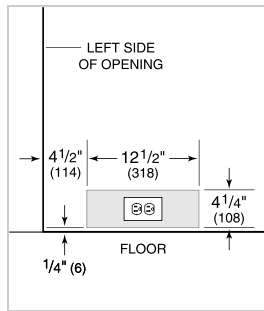

PANEL SPECIFICATIONS For complete panels specifications including width/height, weight requirements and thickness requirements visit subzero-wolf.com/reveal.

NOTE: Dimensions in parenthesis are in millimeters unless otherwise specified

INTERIOR VIEW

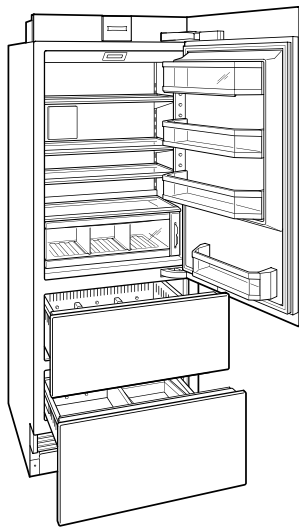

This illustration is intended for interior reference only and may not represent the exterior of the model being specified.

STANDARD INSTALLATION

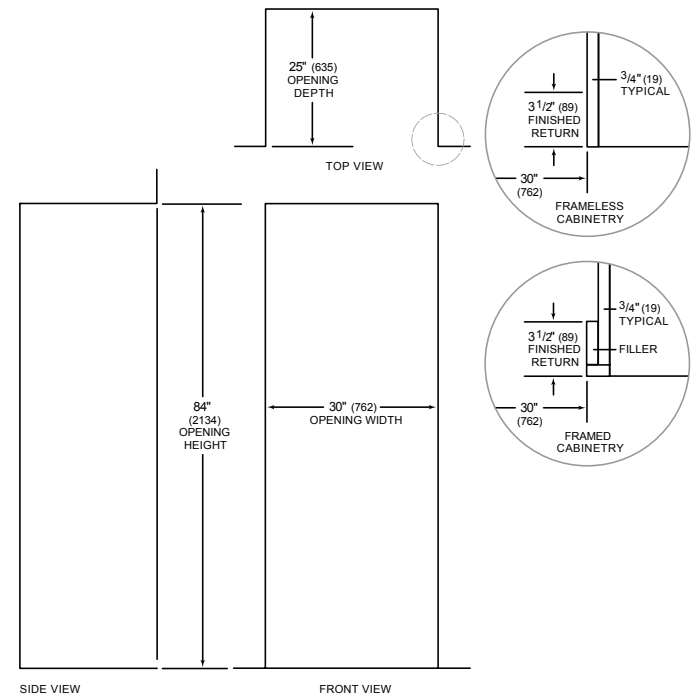

NOTE: 3 1/2" (89) finished returns will be visible and should be finished to match cabinetry