

CSO2450TE/S/T

FEATURES

- Elegant modern aesthetics
- Sleek Full-color LCD Touchscreen
- Features both plumbed and non-plumbed options
- Save up to 50 personalized favorite recipe presets.
- 11 Cooking Modes
- 1750-watt recessed broil element
- 1.7 cubic-foot interior
- Three full-extension rack positions and one standard position
- Large 40-fluid ounce water tank
- Temperature Probe

ACCESSORIES

- Broiler Rack
- Descaling Solution
- Perforated Pan - 12 3/4" x 1 1/2" x 7"
- Perforated Pan - 17 3/4" x 1 1/4" x 15"
- Porcelain Steam Enameled Broil Pan
- Pro Handle
- Solid Pan - 12 3/4" x 1 1/2" x 7"
- Solid Pan - 17 3/4" x 1 1/4" x 15"
- Standard Oven Rack
- Temperature Probe

Accessories available through an authorized dealer.
For local dealer information, visit subzero-wolf.com/locator.



PRODUCT SPECIFICATIONS

| | |
|--------------------------|--------------------------------|
| Model | CSO2450TE/S/T |
| Dimensions | 23 1/2"W x 17 7/8"H x 22 1/2"D |
| Oven Interior Dimensions | 17 1/2"W x 10 3/4"H x 15 1/8"D |
| Overall Capacity | 1.7 cu. ft. |
| Usable Capacity | 1.2 cu. ft. |
| Door Clearance | 14 3/16" |
| Weight | 91 lbs |
| Electrical Supply | 240/208 VAC, 60 Hz |
| Electrical Service | 20 amp dedicated circuit |
| Conduit Length | 4 Feet |

DIMENSIONS

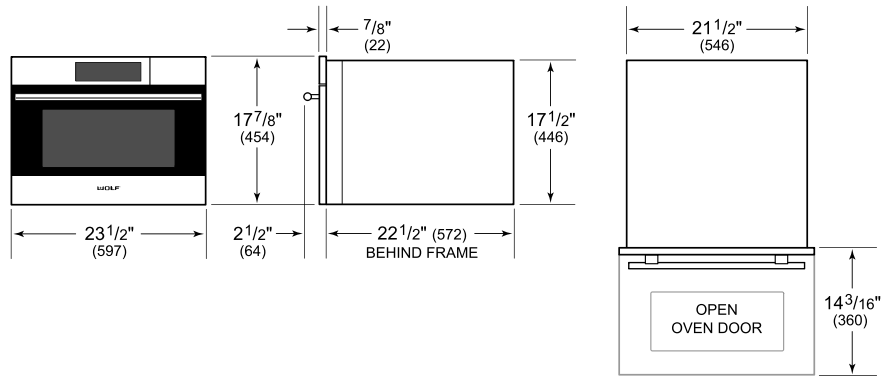

ELECTRICAL

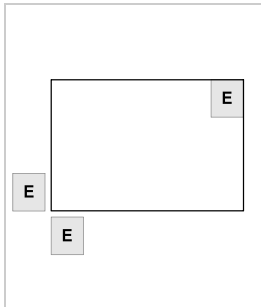

NOTE: Dimensions in parenthesis are in millimeters unless otherwise specified

FLUSH INSTALLATION

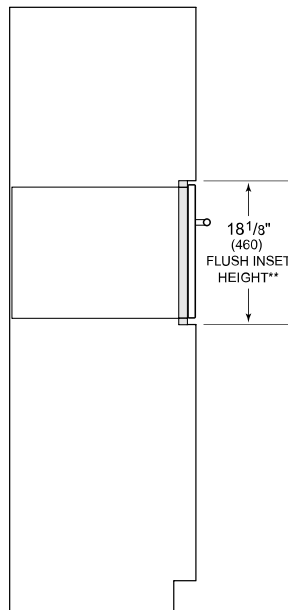
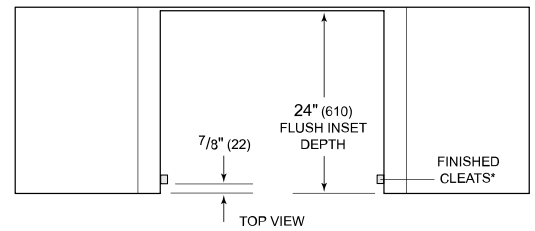

SIDE VIEW

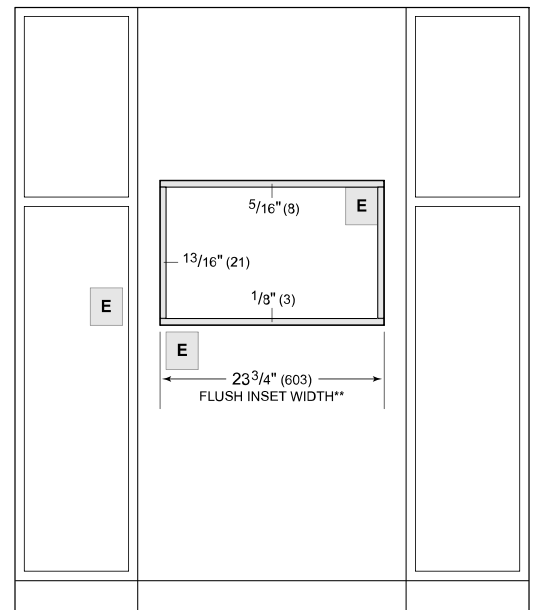

FRONT VIEW

*Will be visible and should be finished to match cabinetry.

**Dimension provides minimum reveals.

NOTE: Location of electrical supply within opening may require additional cabinet depth.