

WWD30



FEATURES

- _____ Rigorously tested for decades of use
- _____ Exceptional support from our Customer Care team in Madison
- _____ Matches Wolf ovens and ranges, or accepts custom panel
- _____ UL approved for warming towels
- _____ 30" wide, it's spacious enough for an entrée and several sides
- _____ Hidden electronic controls
- _____ Temperature range of 80°F to 200°F
- _____ Four preset temperatures make it easy to warm favorite foods
- _____ Automatic shut-off
- _____ Fan assist for even heat distribution that keeps juicy foods juicy, crisp foods crisp
- _____ Removable rack lets you double-stack items
- _____ Full-extension drawer for easy access to foods
- _____ Removable stainless steel drawer pan for easy clean-up

ACCESSORIES

- _____ 30" Contemporary E Series Front Panel
- _____ 30" Professional Drawer Front - E Series
- _____ 30" Stainless Professional Front Panel - 2" Thick
- _____ 36" Stainless Professional Front Panel - 2" Thick
- _____ 6-Piece Container Set
- _____ 814021
- _____ 815837
- _____ 815838
- _____ 818834
- _____ 820395
- _____ Contemporary Handle- E Series
- _____ Warming Drawer Front Panel - Integrated
- _____ Warming Drawer Front Panel - L Series
- _____ Accessories available through an authorized dealer.
For local dealer information, visit subzero-wolf.com/locator.



FRONT PANEL OPTIONS



30" E SERIES TRANSITIONAL



30" E SERIES PROFESSIONAL



30" E SERIES CONTEMPORARY



30" M SERIES CONTEMPORARY



30" M SERIES TRANSITIONAL



30" M SERIES CONTEMPORARY STAINLESS



30" M SERIES PROFESSIONAL



30" L SERIES



30" INTEGRATED

PRODUCT SPECIFICATIONS

Model	WWD30
Dimensions	29 7/8"W x 10 3/8"H x 22 3/4"D
Capacity	1.6 cu. ft.
Weight	100 lbs
Electrical Supply	120 VAC, 60 Hz
Electrical Service	15 amp dedicated circuit
Power Cord Length	3 Feet
Receptacle	3-prong grounding-type

ELECTRICAL

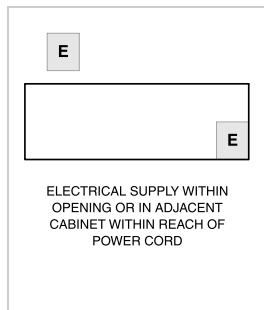

INSTALLATION WITH FRONT PANEL Accessory front panels may affect overall product dimensions and opening dimensions. Refer to [Reveal](http://subzero-wolf.com/reveal) for more information: subzero-wolf.com/reveal

NOTE: Dimensions in parenthesis are in millimeters unless otherwise specified

DIMENSIONS

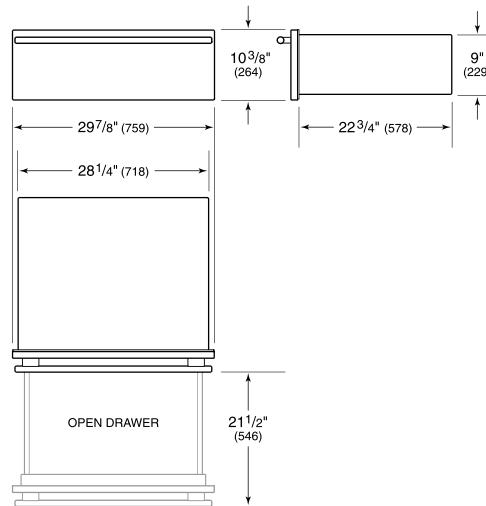

STANDARD INSTALLATION

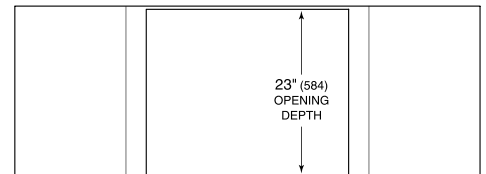

TOP VIEW

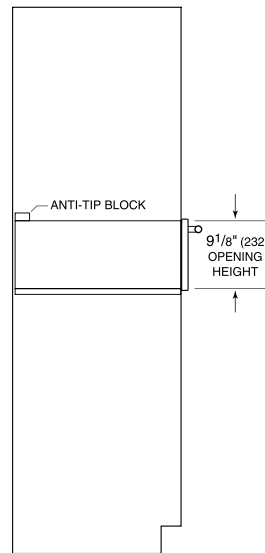

SIDE VIEW

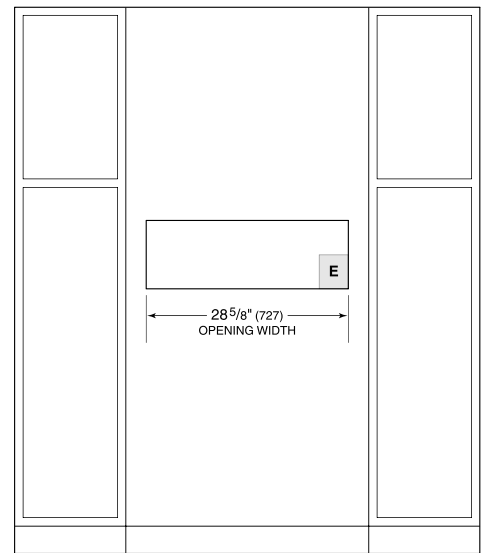

FRONT VIEW

NOTE: Location of electrical supply within opening may require additional cabinet depth.