

WWD300



FEATURES

Distributes heat evenly from 80 to 200 degrees Fahrenheit using fans

Resists corrosion with tested stainless-steel panels that hold up to the outdoor elements

Includes food presets, such as bread, cooked cereals, and pizza

Tested and approved for warming towels

Fits entrées and sides easily in its generous 30 inch drawer cavity

Includes hidden electronic controls

Offers automatic shut-off

ACCESSORIES

30" Stainless Professional Front Panel - 2" Thick

36" Stainless Professional Front Panel - 2" Thick

6-Piece Container Set

Professional Handle-M Series

Warming Drawer Front Panel - Integrated

Accessories available through an authorized dealer.

For local dealer information, visit subzero-wolf.com/locator.



PRODUCT SPECIFICATIONS

Model	WWD300
Dimensions	29 7/8"W x 10 3/8"H x 22 3/4"D
Capacity	1.6 cu. ft.
Weight	75 lbs
Electrical Supply	120 VAC, 60 Hz
Electrical Service	15 amp dedicated circuit
Power Cord Length	3 Feet
Receptacle	3-prong grounding-type

ELECTRICAL

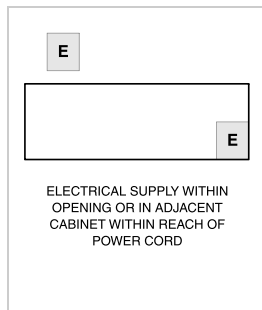

INSTALLATION WITH FRONT PANEL Accessory front panels may affect overall product dimensions and opening dimensions. Refer to Reveal for more information: subzero-wolf.com/reveal

NOTE: Dimensions in parenthesis are in millimeters unless otherwise specified

DIMENSIONS

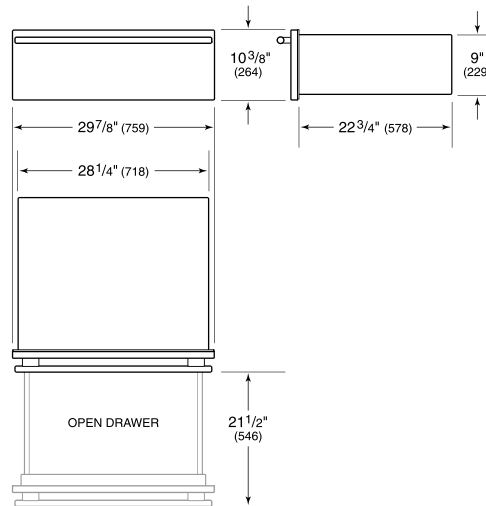

STANDARD INSTALLATION

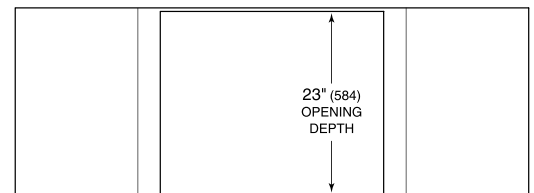

TOP VIEW

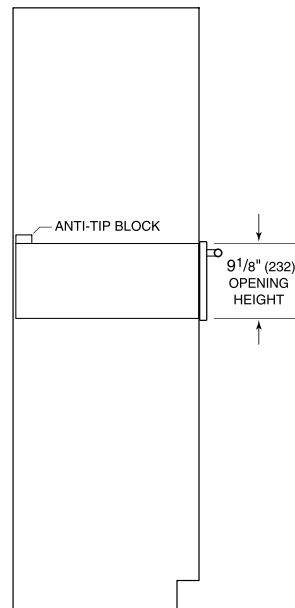

SIDE VIEW

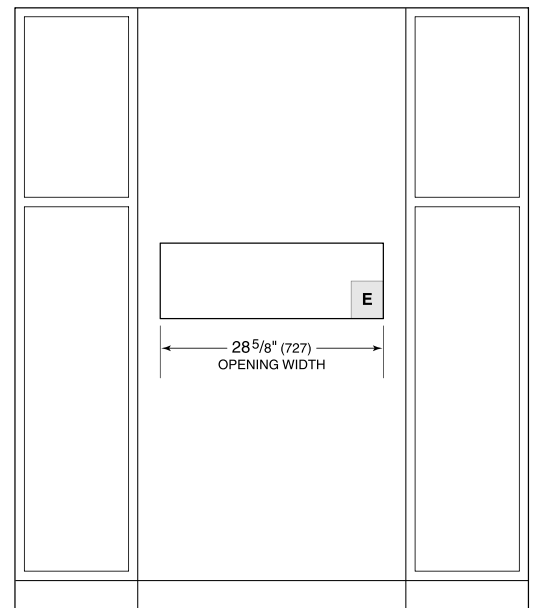

FRONT VIEW

NOTE: Location of electrical supply within opening may require additional cabinet depth.